

# SMD POWER INDUCTORS:

# HSC6040 Series

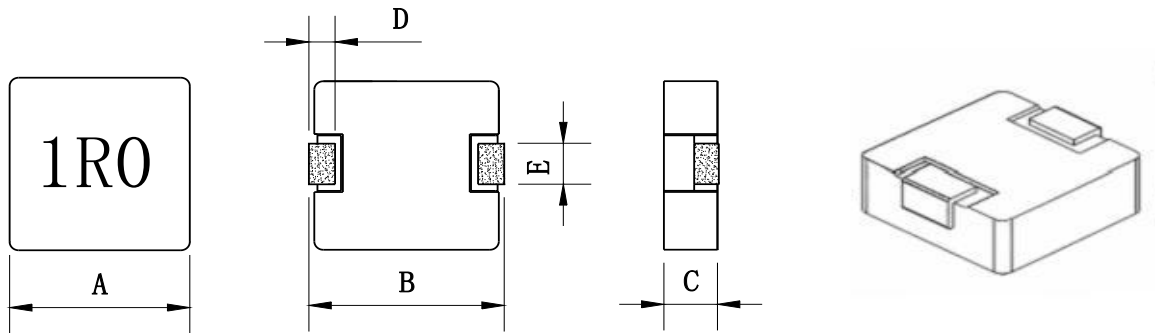

Series	A (mm)	B (mm)	C (mm)	D (mm)	E (mm)
HSC6040	6.6 ± 0.2	7.4MAX	4.0MAX	1.6 ± 0.3	3.0 ± 0.2

Part Number	L0 Inductance (μH) ± 20%	Heat Rating Current Irms (A)	Saturation Current Isat (A)	DCR (mΩ)	
				TYP.	MAX.
HSC6040-R47M-G/B	0.47	12	22.0	3.2	4.0
HSC6040-R68M-G/B	0.68	10.0	20.0	4.4	5.3
HSC6040-R82M-G/B	0.82	9.0	18.0	5.9	7.0
HSC6040-1R0M-G/B	1.0	8.0	16.0	6.4	7.2
HSC6040-1R5M-G/B	1.5	7.0	14.0	8.1	9.7
HSC6040-2R2M-G/B	2.2	6.0	12.0	13.0	17.0
HSC6040-3R3M-G/B	3.3	5.5	11.0	21.4	25.0
HSC6040-4R7M-G/B	4.7	5.0	9.0	27.5	35.0
HSC6040-6R8M-G/B	6.8	5.0	9.0	36.0	45.0
HSC6040-8R2M-G/B	8.2	4.0	8.0	44.0	50.0
HSC6040-100M-G/B	10.0	3	6.0	56.0	65.0
HSC6040-150M-G/B	15	2.5	5.0	67.0	80.0
HSC6040-220M-G/B	22.0	2.5	4.0	80.0	92.0

\*: you require another part number please contact with us.

\*\* : Inductance Tolerance ± 20%

Note 1: All test data is referenced to 25°C ambient.

Note 2: Idc : DC current (A) that will cause an approximate ΔT of 40°C

Note 3: Isat : DC current (A) that will cause Lo to drop approximately 30%

# SMD POWER INDUCTORS:

HSC-6040M Series

## 1. Reel Dimension

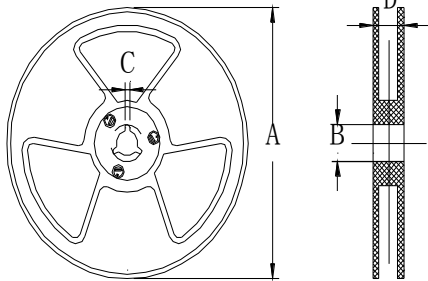

规格 尺寸	13"
A	$\Phi 330 \pm 2.0\text{mm}$
B	$\Phi 76.5 \pm 2.0\text{mm}$
C	2.3mm
D	16mm (载带 $13.3 \pm 0.15\text{mm}$ )

## 2. Tape Dimension

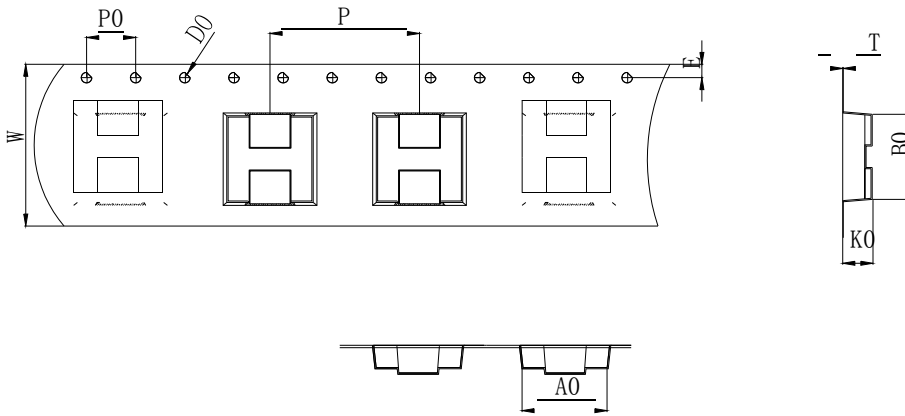

Size	W (mm)	A0 (mm)	B0 (mm)	D0 (mm)	E (mm)	K0 (mm)	P0 (mm)	P (mm)	T (mm)
60 0	$16.0 \pm 0.3$	$6.8 \pm 0.1$	$7.3 \pm 0.1$	$1.5 \pm 0.1$	$1.75 \pm 0.1$	$4.0 \pm 0.1$	$4.0 \pm 0.1$	$12.0 \pm 0.1$	$0.3 \pm 0.05$

## 3. Packaing Quantity

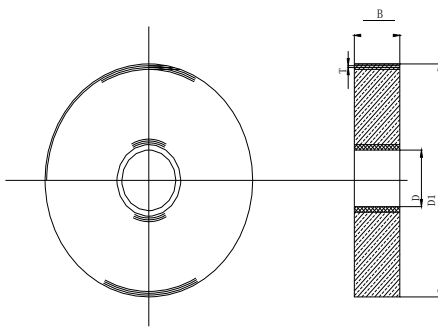

包装单位	包装尺寸	包装数量
1 盘	330*29mm	1000pcs
1 盒2 盘	34*6.5*34cm	2000pcs
1 箱2 盒	35.5*28.5*36.5cm	4000pcs